

REV: 02102013

## Rectifier Module 18VDC / 1125A Output

### PRODUCT FEATURES:

- Power rectifier for ballast water treatment
- Wide-range input voltage (3Ø, 375VAC ~ 510VAC)
- Compact, modular design (easy module replacement)
- High power density; water-cooled design
- Parallel connection, up to 8 modules
- Output current & voltage control modes
- Soft start for safe, energy-efficient operation
- LED alarm indicators
- Constant electric power control



### INPUT SPECIFICATIONS:

VOLTAGE	440VAC, 3Ø (375VAC ~ 510VAC)
FREQUENCY	47-63Hz
INRUSH	50A @ 440VAC per module
CURRENT	30A @ 440VAC (Max Continuous) per module
PROTECTION	UVP, OVP, IGBT Ic P/T, A Fuse per phase
LEAKAGE	≤3.5mA @ 440VAC, per module
EFFICIENCY	>85%
HARMONICS	EN61000-3-2 Class D Compliant (>0.90PF)
PROTECTION	Input Undervoltage, Overvoltage

### OUTPUT SPECIFICATIONS:

Vout	18V DC, max
Iout (DC)	1125A (1300A at 15Vout)
ADJUSTMENT RANGE	1V DC ~ 18V DC
LINE REGULATION	±2% max, across full input range
LOAD REGULATION	±2% max, across full output range
TEMP REGULATION	±2% Maximum
SETPOINT ACCURACY	±0.5%
OVER CURRENT	105~120%
OV PROTECTION	19VDC (recycle input to reset)
TEMP PROTECTION	Thermal Shutdown

### STATUS & CONTROL SIGNALS:

CURRENT SHARE	<10% of nominal current
---------------	-------------------------

### GENERAL SPECIFICATIONS:

OPERATING TEMP	0°C to +55°C
STORAGE TEMP	-25°C to +75°C
WATER TEMP	0°C to +40°C
OPERATING HUMIDITY	10% to 95% (non-condensing)
STORAGE HUMIDITY	5% to 95% (non-condensing)
COOLING	Cooling water
VIBRATION	2-100Hz, 0.7G, 120min period each (3 axes)
RELIABILITY	150,000 hours MTBF (per MIL STD 217F)
ALTITUDE	0~10,000 Feet
SIZE (W×D×H)	390mm×356mm×250mm (Module)

### ELECTROMAGNETIC COMPATIBILITY:

EMISSIONS	CISPR 16-1,16-2
ELECTROSTATIC DISCHARGE	IEC61000-4-6
RADIATED SUSCEPTIBILITY	
EFT / BURSTS	IEC61000-4-4 LEVEL 3
SURGE	
CONDUCTED IMMUNITY	IEC61000-4-5 LEVEL 2
VOLTAGE DIPS	IEC61000-4-6 LEVEL 2
VOLTAGE INTERRUPTIONS	IEC61000-2 LEVEL 3



OUTLINE DRAWING:

**BREC-18 Module**

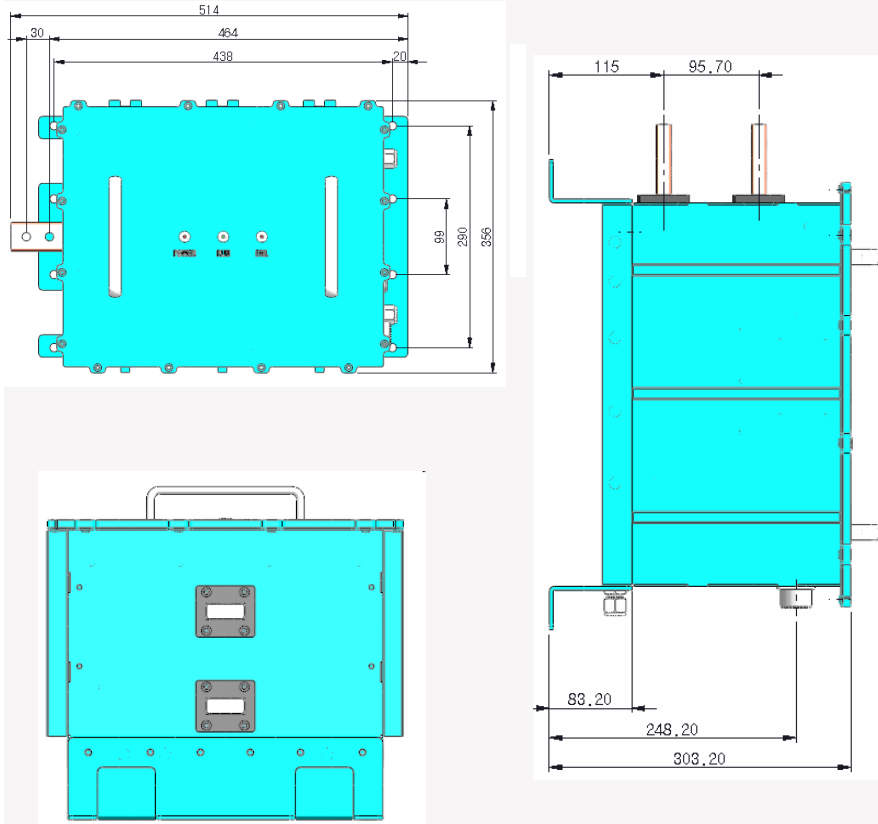

**BREC-18 1set**

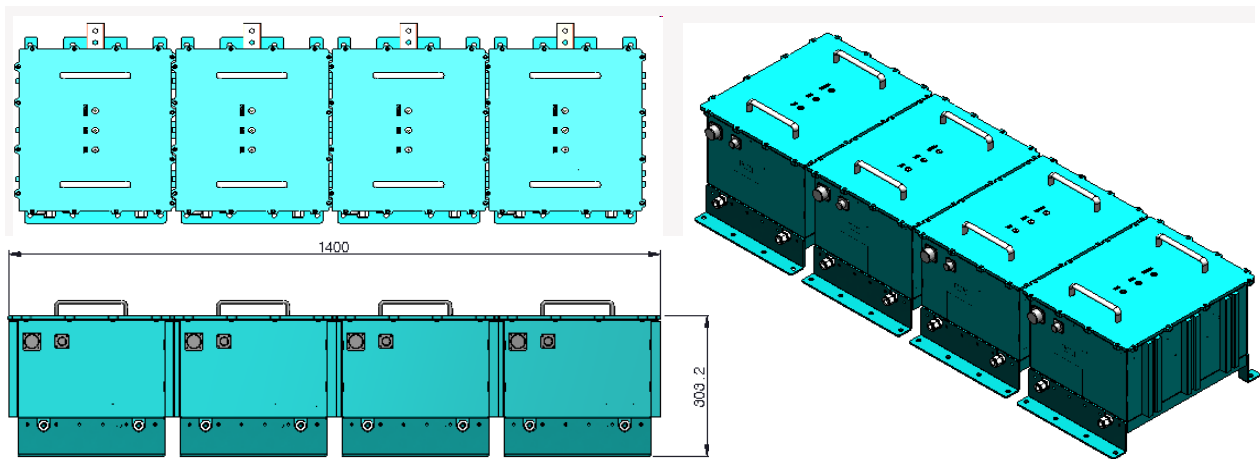

ITE / EMBEDDED POWER SUPPLY

